

SHADE SAILS PROGRAM 2018 -

Proposed shade sails Balmain and Leichhardt wards

BALMAIN WARD



Campbell Street, Balmain

The shade sails will provide shade over the slide and swing



College Street Balmain

The shade sails will provide shade over the toddlers slide and carousel

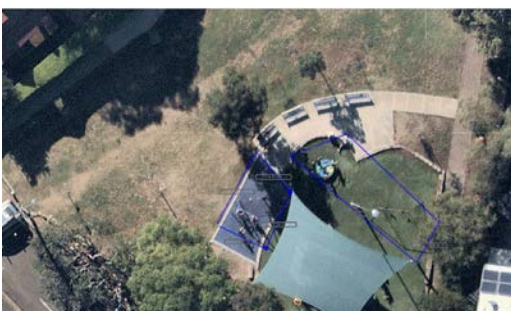

O'Connell Reserve Rozelle

The shade sails will provide shade over the swings and carousel



King George Park Fitness Station, Rozelle

The shade sails will provide shade over the northern end of the fitness station

LEICHHARDT WARD



Pine Square Leichhardt

The shade sails will provide shade over the swing

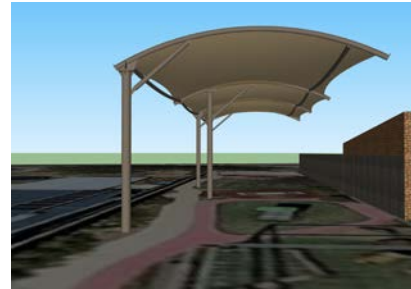

Nestor Park, Hearn Street Leichhardt

The shade sails will provide shade over the slide, see-saw and swing

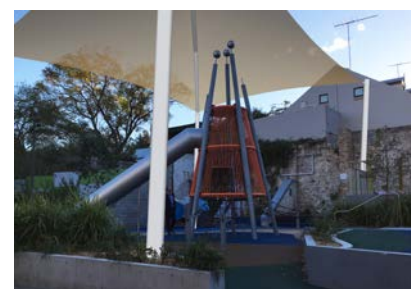

Douglas Grant Park, Chester Street Annandale

The shade sails will provide shade over the slide and spinner



Gray Street Park Annandale

The shade sails will provide shade over the spinner and swing



Marr Reserve, Excelsior Street Leichhardt

The shade sails will provide shade over the multi-play unit and swing

As part of the Shade Sails Program 2018, Council is proposing to install shade sails in the suburbs of Leichhardt, Annandale, Rozelle and Balmain. The proposed sails will provide shade over playgrounds and fitness facilities to promote a healthier lifestyle and safe play environment.

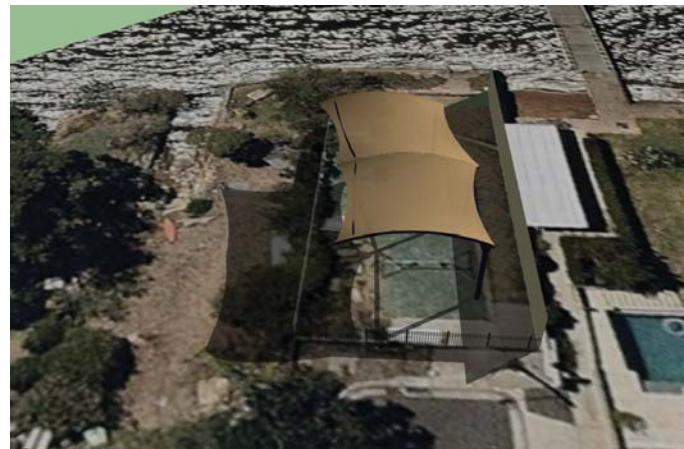

Summer Dec 21st 8am



Summer Dec 21st 10am



Summer Dec 21st 2pm



Summer Dec 21st 4pm



Winter Jun 21st 8am



Winter Jun 21st 10am

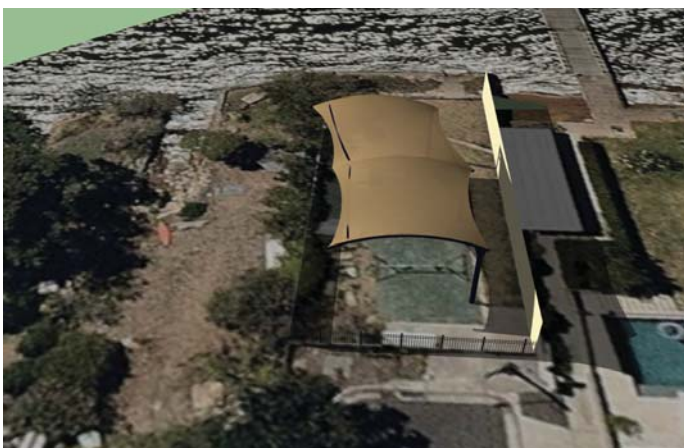

Winter Jun 21st 2pm

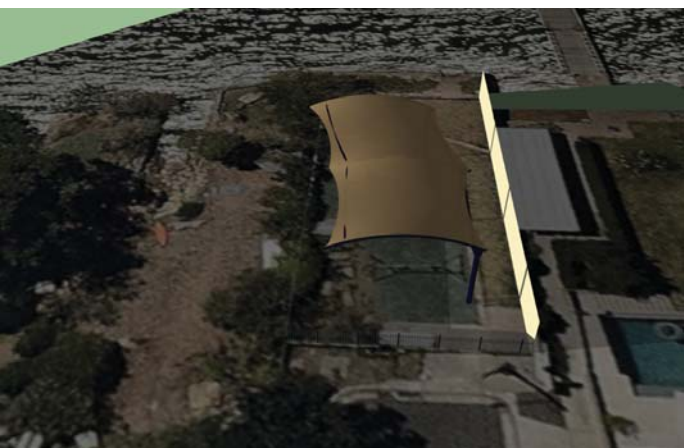

Winter Jun 21st 4pm



Plan



Street view

SHADE SAILS PROGRAM BALMAIN

Campbell Street
Proposed shade sails over swing and slide unit

12.09.18 issue
PRELIM



Plan



Summer Dec 21st 10am

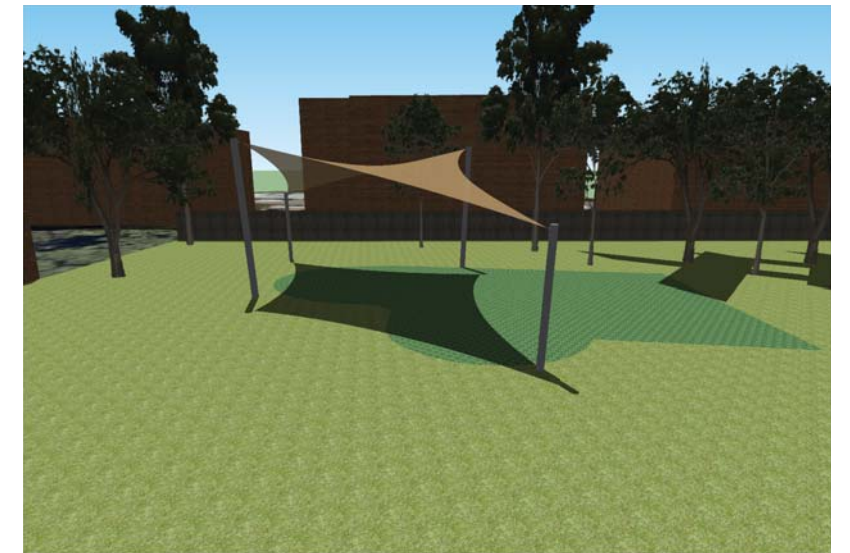

Summer Dec 21st 2pm



Perspective



Winter Jun 21st 10am



Winter Jun 21st 2pm

SHADE SAILS PROGRAM BALMAIN

College Street

Proposed shade sails over toddlers slide and carousel

12.09.18 issue
PRELIM



⊕ Plan

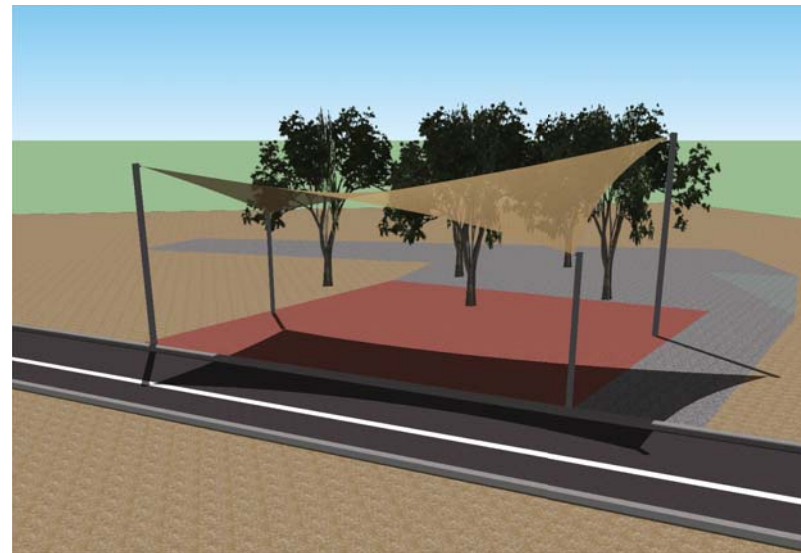

Summer Dec 21st 10am

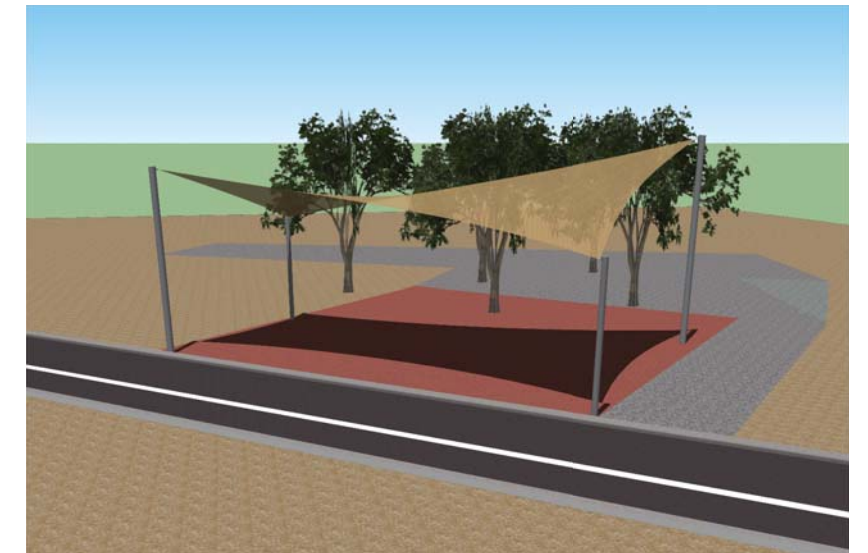

Summer Dec 21st 2pm



Street view



Winter Jun 21st 10am



Winter Jun 21st 2pm

SHADE SAILS PROGRAM ROZELLE

King George Park Fitness Station
Proposed shade sails over northern fitness equipment

12.09.18 issue
PRELIM

Views from Whites Creek Lane



Summer Dec 21st 8am



Summer Dec 21st 10am



Summer Dec 21st 2pm



Summer 21st Dec 4pm



Winter Jun 21st 8am



Winter Jun 21st 10am



Winter Jun 21st 2pm



Winter Jun 21st 4pm

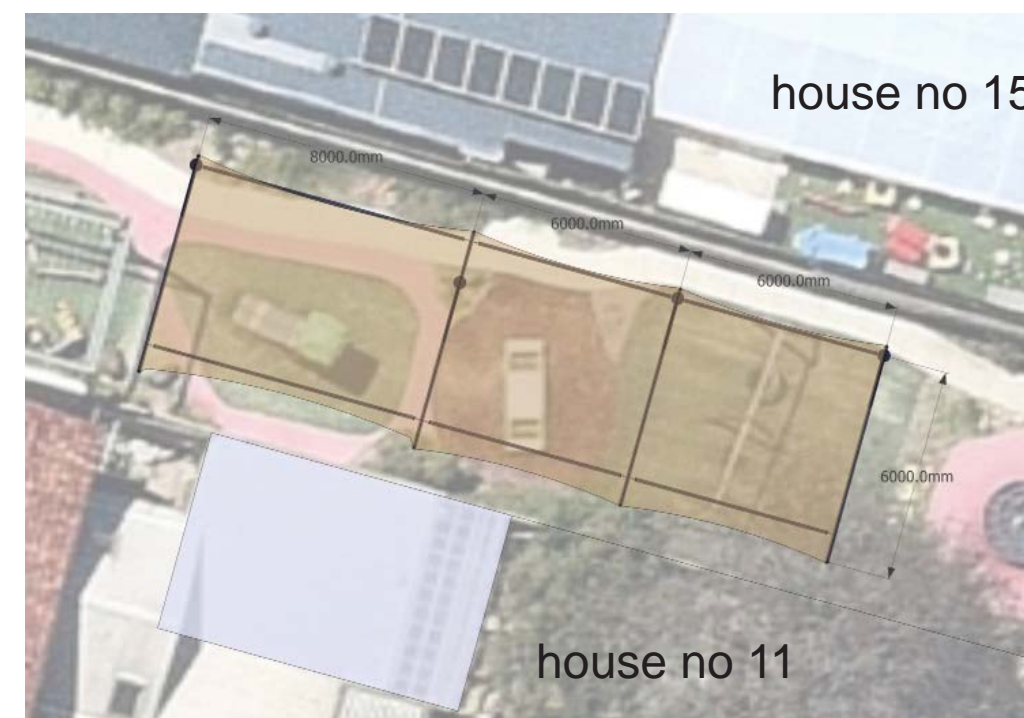

⊕ Plan

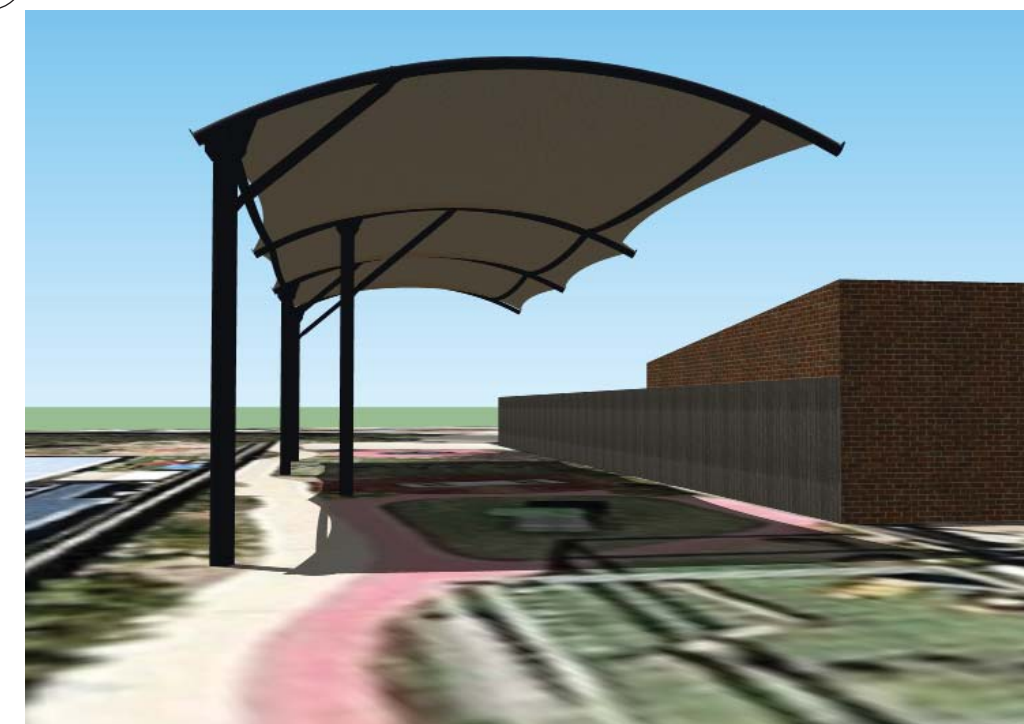

Perspective looking from Hearn Street

SHADE SAILS PROGRAM LEICHHARDT

Nestor Park Hearn Street

Proposed shade sails over swings, slide and see-saw

12.09.18 issue
PRELIM



Summer Dec 21st 8am

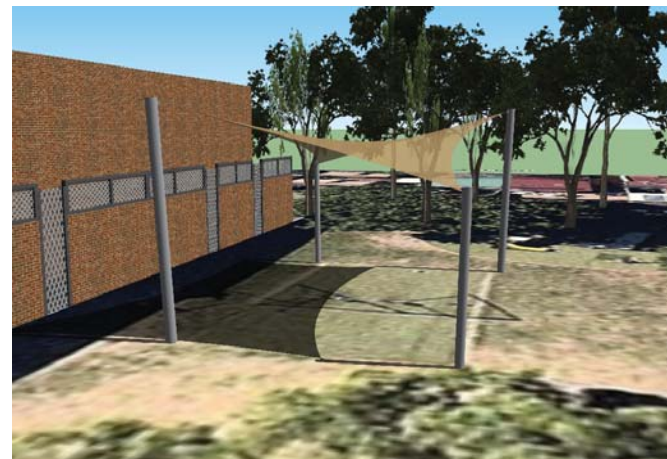

Summer Dec 21st 10am



Summer Dec 21st 2pm

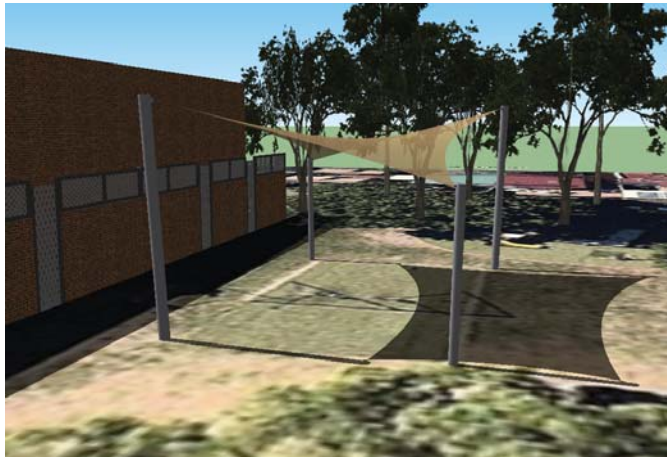

Summer Dec 21st 4pm



Winter Jun 21st 8am



Winter Jun 21st 10am



Winter Jun 21st 2pm



Winter Jun 21st 4pm



Plan



Perspective

SHADE SAILS PROGRAM LEICHHARDT

Pine Square Street
Proposed shade sails over swings

12.09.18 issue
PRELIM



Plan

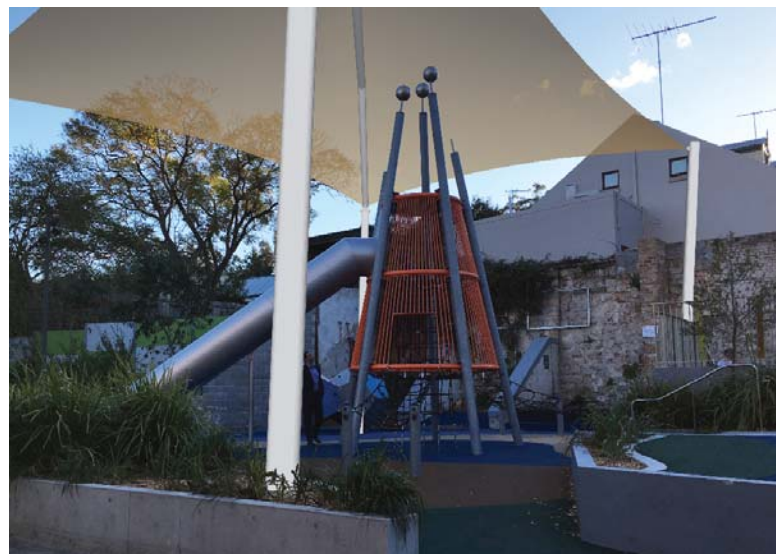

Perspective

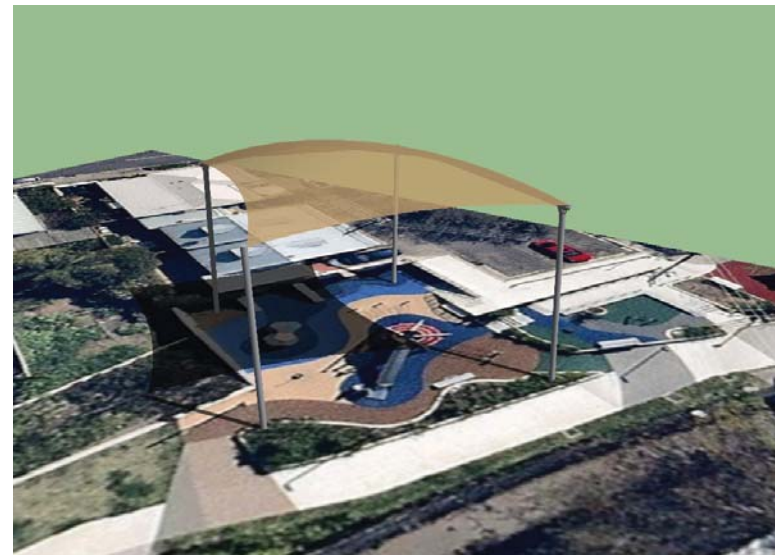

Summer Dec 21st 10am

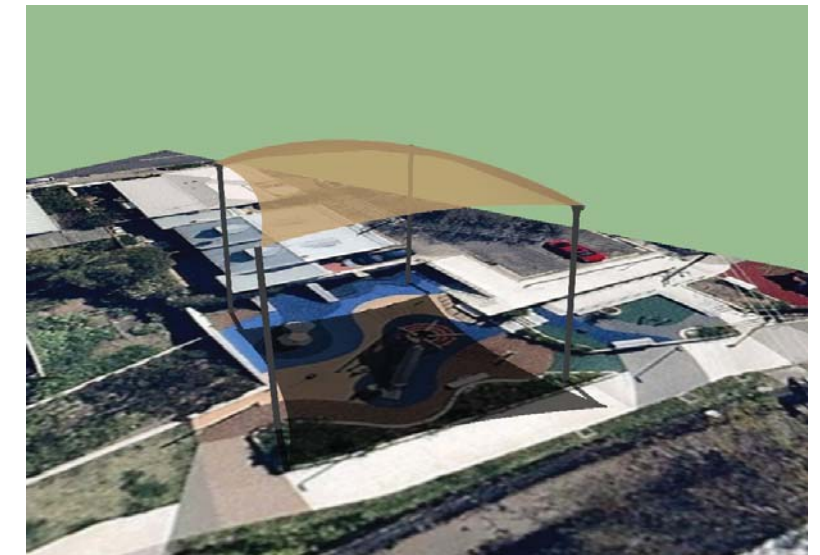

Summer Dec 21st 2pm



Winter Jun 21st 8am

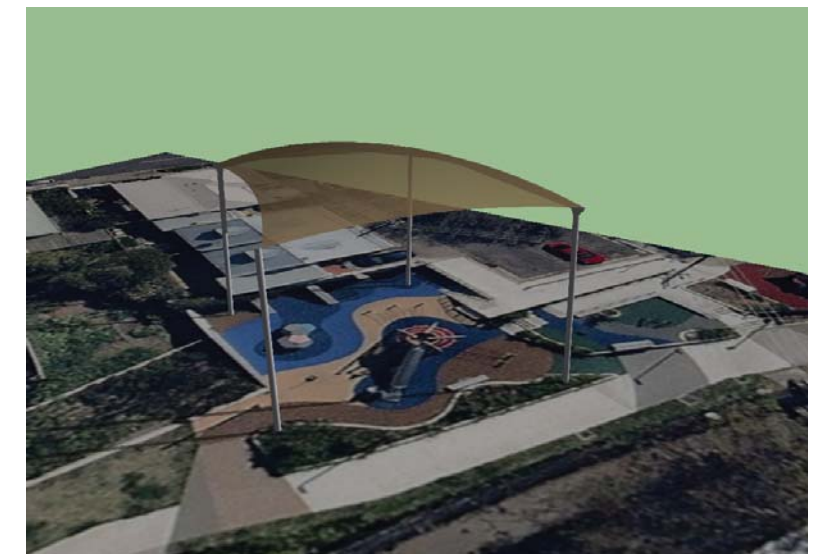

Winter Jun 21st 9am

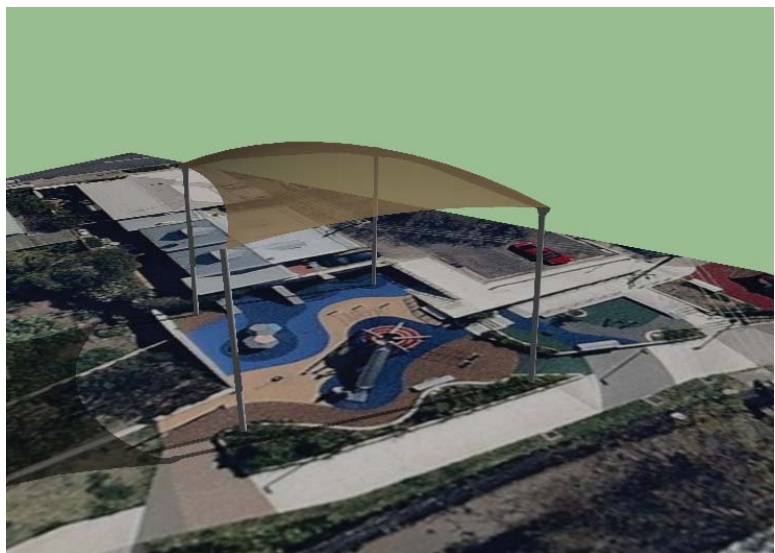

Winter Jun 21st 10am

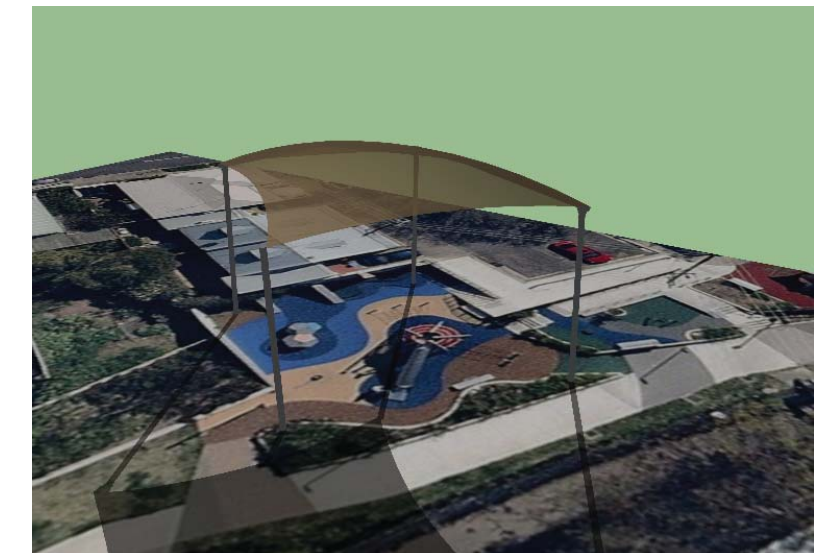

Winter Jun 21st 2pm

SHADE SAILS PROGRAM ANNANDALE

Douglas Grant Park Playground

Proposed shade sails over slide, spinner and blox

12.09.18 issue
PRELIM
rev 01

SHADE SAILS PROGRAM 2018

Proposed shade sails Technical Information

As the shade sails are being proposed and have not been designed yet, the following information is generic and indicative.

Location

The areas for the shading shown on the plans are indicative with proposed shade for the selected equipment described.

Posts

There will generally be 4 posts per shade sail, comprising of shorter post on the western and eastern sides and taller post on the northern and southern sides. This is to provide optimum shade from the western sun while allowing some northern sunlight.

The shorter post heights will range from 3m to 4m while the taller posts will range from 4.5m to 7m.

Preliminary concept designs have been prepared for six of the sites:



Campbell Street, Balmain

The shade sails will provide shade over the slide and swing
Post height 3.2m (one height for cantilever structure)



College Street Balmain

The shade sails will provide shade over the toddlers slide and carousel
Post heights: 3m low posts, 5m tall posts



King George Park Fitness Station, Rozelle

The shade sails will provide shade over the northern end of the fitness station

Post heights: 4m low, 6m northern post, 7m southern post



Pine Square Leichhardt

The shade sails will provide shade over the swing

Post heights: 3m low posts, 4.5m tall posts



Nestor Park, Hearn Street Leichhardt

The shade sails will provide shade over the slide, see-saw and swing

Post height: 4m (one height for cantilever structure)



Douglas Grant Park, Chester Street Annandale

The shade sails will provide shade over the slide and spinner

Post heights: 8m minimum clearance on all corners, approx. 10m overall height in the centre