

A3 Fold Out Master Plan to accompany  
Draft Plan of Management + Master Plan for Pratten Park  
July 2020

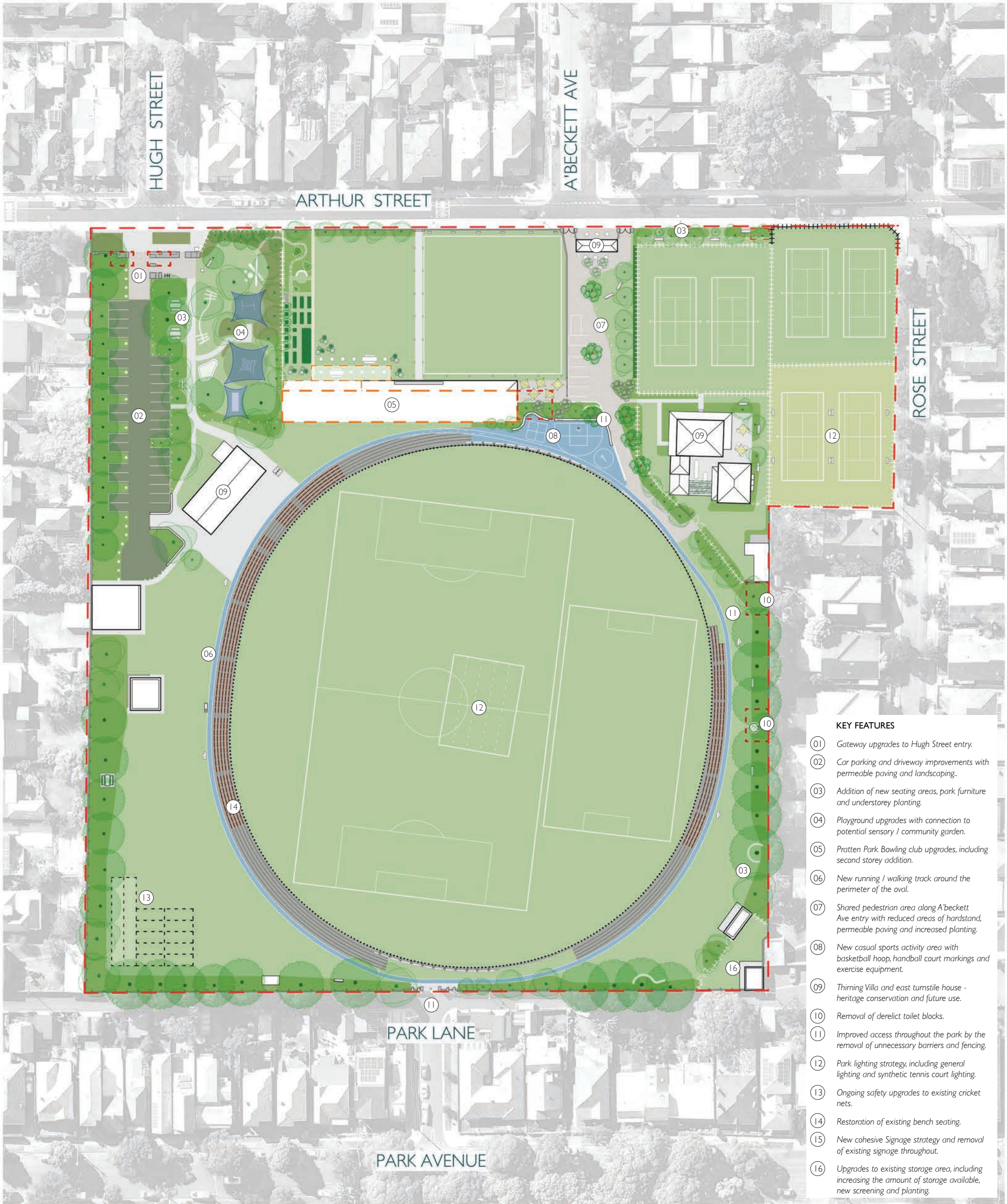

- KEY FEATURES**
- 01 Gateway upgrades to Hugh Street entry.
  - 02 Car parking and driveway improvements with permeable paving and landscaping.
  - 03 Addition of new seating areas, park furniture and understorey planting.
  - 04 Playground upgrades with connection to potential sensory / community garden.
  - 05 Pratten Park Bowling club upgrades, including second storey addition.
  - 06 New running / walking track around the perimeter of the oval.
  - 07 Shared pedestrian area along A'Beckett Ave entry with reduced areas of hardstand, permeable paving and increased planting.
  - 08 New casual sports activity area with basketball hoop, handball court markings and exercise equipment.
  - 09 Thirning Villa and east turnstile house - heritage conservation and future use.
  - 10 Removal of derelict toilet blocks.
  - 11 Improved access throughout the park by the removal of unnecessary barriers and fencing.
  - 12 Park lighting strategy, including general lighting and synthetic tennis court lighting.
  - 13 Ongoing safety upgrades to existing cricket nets.
  - 14 Restoration of existing bench seating.
  - 15 New cohesive Signage strategy and removal of existing signage throughout.
  - 16 Upgrades to existing storage area, including increasing the amount of storage available, new screening and planting.

LEGEND					
Natural Grass / Sports Field	New Sports Surface	Master Plan boundary	Shared Space	New Tree	
Existing Synthetic Turf	Existing Buildings	Zone Boundary	Pedestrian Area	Existing Tree	
New Understorey Planting	New Buildings	Existing Fencing	Car Park	Existing Phoenix Palm	
Existing Understorey Planting	Removed Structure	New Fencing	Marked Car Spaces	Sensory / Tucker Garden	
New Walking / Running Track	Cricket Netting	New Bollard Style Barrier	Informal Path	Community / Veg Garden	

0 10 20 40m  
SCALE 1:1000 @ A3

